

AFTERNOON GRAPE PHOMOPSIS WORKSHOP

Upton 101

1:30 What Worked and What Didn't in Phomopsis Control in 2010
Diane Brown, Berrien County Horticulture Educator

1:50 The Biology and Control of Phomopsis
Mike Ellis, Ohio State University

2:40 Different Approaches to Phomopsis Management
Annemiek Schilder, MSU Department of Plant Pathology

AFTERNOON TREE FRUIT SESSION

North Training

1:30 Plum Varieties for the Fresh Market
Mira Danilovich, MSU Tree Fruit Extension Educator

2:00 Connecting Plum Growers and Buyers-Panel Discussion
Nick Nyblad (Kent City), Paul Rood (Covert), and Don Armock (Grand Rapids)

2:30 Strategies for Combating Viruses in Tree Fruits
Bill Shane, District Extension Educator, MSU Southwest Michigan Research and Extension Center

AFTERNOON BERRY SESSION

North Exhibit Lobby

1:30 Understanding and Using Adjuvants for Spray Efficacy
Daniel Bergman, Loveland Industries, Iowa

2:15 Blackberry Culture Options and Varieties You Should Consider
Eric Hanson, MSU Department of Horticulture

3:00 China's Blueberry Production Revisited- How Big a Threat is it?
Mark Longstroth, MSU Small Fruit Extension Educator

Thursday afternoon concurrent sessions end at 3:30

**GRAND DOOR PRIZE DRAWING AT 3:30 P.M.
ON THURSDAY
Grand Upton Hall**

The information given herein is supplied with the understanding that no discrimination is intended and no endorsement by MSU Extension is implied. MSU is an affirmative-action, equal-opportunity employer. Michigan State University Extension programs and materials are open to all without regard to race, color, national origin, gender, gender identity, religion, age, height, weight, disability, political beliefs, sexual orientation, marital status, family status, or veteran status.

Persons with disabilities may request accommodations by calling the Van Buren County MSU Extension office at 269-657-8213 by January 28 to ensure sufficient time to make arrangements. Requests made less than two weeks before event will be met when possible.



LODGING:

We suggest the Holiday Inn Express at the Pipestone exit (I-94 Exit 29). Rooms can be reserved for Southwest Michigan Horticultural Days participants on the nights of February 2 & 3 for a conference rate of \$79.99. Call the Holiday Inn Express directly at (269) 927-4599 and mention Southwest Michigan Horticultural Days when making the reservation.

RUP Credits have been requested but are not confirmed at this time.

HOSPITALITY SESSION will be held in the Conference Room at SW Michigan Research and Extension Center from 4:30-7:00 pm on Wednesday, February 2, 2011.
1791 Hillandale Road
Benton Harbor, MI



**MICHIGAN STATE
UNIVERSITY
EXTENSION**

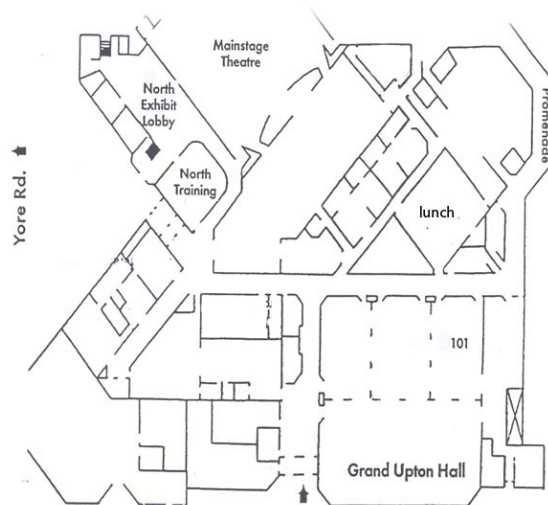

Mendel Center First Floor

2011

SOUTHWEST MICHIGAN HORTICULTURAL DAYS

February 2 & 3, 2011

LAKE MICHIGAN COLLEGE

MENDEL CENTER

BENTON HARBOR, MI

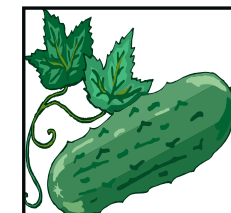
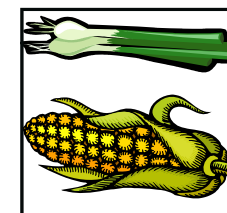
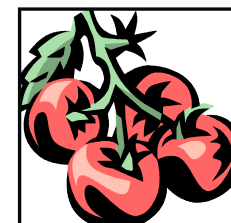
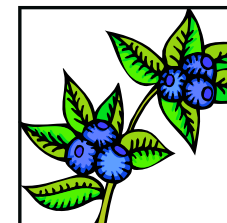
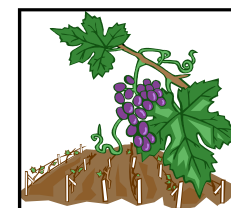
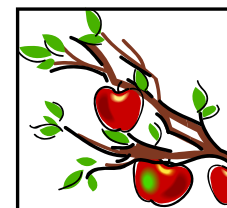

Sponsored by

The Michigan Grape Society

Michigan State University Extension

Lake Michigan College

Michigan State Horticultural Society

WEDNESDAY, FEBRUARY 2, 2011

GENERAL OPENING SESSION

Upton 101

8:00 AM Registration & Visit Exhibits

9:00-12:00 GENERAL SESSION

9:00 GAP– Where Are We One Year Later?

Phil Tocco, MSU Extension

9:45 Working with Department of Labor and MDA
Agricultural Workers Housing Inspectors– What
Growers Need to Know

*Brooke Avello, US Department of Labor, and Mark Swartz,
Michigan Department of Agriculture*

10:30 Break

10:50 Coming Changes in the Michigan Department of
Agriculture

*Keith Creagh, Director, Michigan Department of Agriculture and
Rural Development*

11:25 Changing Regulations for Insecticides, and
Insecticide Efficacy Ratings for Spotted Wing
Drosophila (SWD) and Brown Marmorated Stink Bug

Mark Whalon, MSU Department of Entomology

Grand Upton Hall

12:00– 1:30 Lunch-Visit Exhibits

DOOR PRIZE DRAWING AT 1:00 P.M.

AFTERNOON CONCURRENT SESSIONS

1:30- 4:00 TREE FRUIT **Upton 101**

1:30- 4:15 VEGETABLE **North Training**

1:30- 4:00 GRAPE **North Exhibit Lobby**

4:30-7:00 HOSPITALITY SESSION

Conference Room, SW Michigan Research and Extension Center; 1791
Hillandale Road, Benton Harbor. Wine & Hors d'oeuvres will be
served.

AFTERNOON TREE FRUIT SESSION

1:30 Tree Fruit Disease Management Update
George Sundin, MSU Department of Plant Pathology

2:20 Update on Key Pesticides and Insect Pests in Orchard
Systems
Mark Whalon, MSU Department of Entomology

3:00 Break

3:15 Cover Crop Strategies for Fruit Crops
Dale Mutch, MSU Kellogg Biological Station

AFTERNOON VEGETABLE SESSION

1:30 Staying ahead of Phytophthora Crown and Root Rot in
Squash
Michael Meyer, MSU Department of Plant Pathology

1:55 Onion Botrytis Leaf Blight and Downy Mildew
Lina Rodriguez, MSU Department of Plant Pathology

2:20 Management of Tomato Late Blight
Tiffany Enzenbacher, MSU Department of Plant Pathology

2:45 Break

3:00 The Mighty Mite: Biology and Management of Mites in
Michigan Vegetable Crops
Alexandria Bryant, MSU Department of Entomology

3:25 Low Tunnel Cucumber and Tomato Production
Rebekah Struck, MSU Department of Horticulture

3:50 Tillage and Cover Cropping Strategies for Sweet Corn
Ben Henshaw, MSU Department of Horticulture

AFTERNOON GRAPE BERRY MOTH WORKSHOP

1:30 What Worked and What Didn't in Grape Berry Moth
Control in 2010
Diane Brown, Berrien County Horticulture Educator

1:50 Effective and Economical Management of Grape Berry
Moth
Rufus Isaacs, MSU Department of Entomology

2:40 Break

3:00 Grape Berry Moth Control Strategies in New York
Speaker TBA

DOOR PRIZE DRAWING AT 4:15 P.M.

THURSDAY, FEBRUARY 3, 2011

MORNING CONCURRENT SESSIONS

9:00-12:00 TREE FRUIT **North Training**

9:00-12:00 GRAPE **Upton 101**

9:00-12:00 BLUEBERRY SESSION **North Exhibit Lobby**

MORNING TREE FRUIT SESSION

9:00 Understanding and Using Adjuvants for Spray Efficacy
Daniel Bergman, Loveland Industries, Iowa

9:50 Wind Machines and Other Strategies for Reducing
Freeze Injury to Fruit Crops
*Hugh Fraser, Ontario Ministry of Agriculture, Food and
Rural Affairs*

10:30 Break

MORNING TREE FRUIT SESSION, CONT.

10:50 Tree Fruit Insect Management Update
*Mike Haas, Peter McGhee and Larry Gut, MSU
Department of Entomology*

11:20 Grafting and Topworking Fruit Trees
*Robbi VanTimmeren, VanTimmeren Grafting Services,
Grand Rapids, MI*

MORNING GRAPE SESSION

9:00 Managing Highly Vigorous Concord Grapevines
*Tom Zabadal, MSU Department of Horticulture, and
SW MI Research & Extension Center*

9:45 Michigan Grape Society Meeting

10:00 Break

10:20 Preparing for New Invasive Insect Pests of
Grapes
Rufus Isaacs, MSU Department of Entomology

11:00 Information Resources for Michigan's Grape
Industries
*Paul Jenkins, Small Fruit Education Outreach
Coordinator, MSU IPM Program*

11:30 Relationship Between Yield and Fruit Quality in
Concord Vines
Paolo Sabbatini, MSU Department of Horticulture

MORNING BLUEBERRY SESSION

9:00 SWD Spotted Wing Drosophila: Biology,
Monitoring, and Management
Rufus Isaacs, MSU Department of Entomology

9:45 Controlling Phomopsis in Blueberries
*Annemieck Schilder, MSU Department of Plant
Pathology*

10:30 Break

11:00 Current Weed Control Strategies in Blueberries
Eric Hanson, MSU Department of Horticulture

11:30 Strategies to Maximize Profit in Blueberries
Mark Longstroth, Small Fruit Educator, MSUE

Grand Upton Hall

12:00-1:30 — Lunch — Visit Exhibits

DOOR PRIZE DRAWING AT 1:00 P.M.

AFTERNOON CONCURRENT SESSIONS

1:30-3:30 GRAPE **Upton 101**

1:30-3:30 TREE FRUIT **North Training**

1:30-3:30 BERRIES **North Exhibit Lobby**